

Bearing technology | Plain bearing | iglidur® Q290

Sleeve bearing (form S)

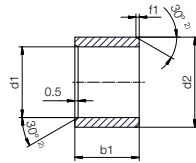

²⁾ Thickness < 0.6mm: Chamfer = 20°

i Dimensions according to ISO 3547-1 and special dimensions

Chamfer in relation to d1

d1 [mm]	Ø 12–30	Ø > 30
f1 [mm]	0.8	1.2



Order example: **Q290SM-2023-20** – no minimum order quantity.

Q290 iglidur® material **S** Sleeve bearing **M** Metric **20** Inner Ø d1 **23** Outer Ø d2 **20** Total length b1

d1 [mm]	d1 Tolerance ³⁾	d2 [mm]	b1 h13 [mm]	Part No.
20.0		23.0	20.0	Q290SM-2023-20
25.0	+0.040 +0.124	28.0	30.0	Q290SM-2528-30
30.0		34.0	30.0	Q290SM-3034-30
30.0		34.0	40.0	Q290SM-3034-40
35.0	+0.050 +0.150	39.0	30.0	Q290SM-3539-30
35.0		39.0	40.0	Q290SM-3539-40
35.0		39.0	50.0	Q290SM-3539-50
40.0		44.0	40.0	Q290SM-4044-40
50.0		55.0	50.0	Q290SM-5055-50
60.0	+0.060 +0.180	65.0	60.0	Q290SM-6065-60
65.0		70.0	60.0	Q290SM-6570-60
70.0		75.0	60.0	Q290SM-7075-60
80.0		85.0	100.0	Q290SM-8085-100

³⁾ After press-fit. *Testing methods, page 57*



Available from stock

Detailed information about delivery time online.

www.igus.sk/24



Online ordering

Including delivery times, prices, online tools

www.igus.sk/Q290



Ordering note

Our prices are scaled according to order quantities, current prices can be found online.

Discount scaling		
1 – 9	50 – 99	500 – 999
10 – 24	100 – 199	1,000 – 2,499
25 – 49	200 – 499	2,500 – 4,999

No minimum order value.

No low-quantity surcharges.

Free shipping within Germany for orders above €150.

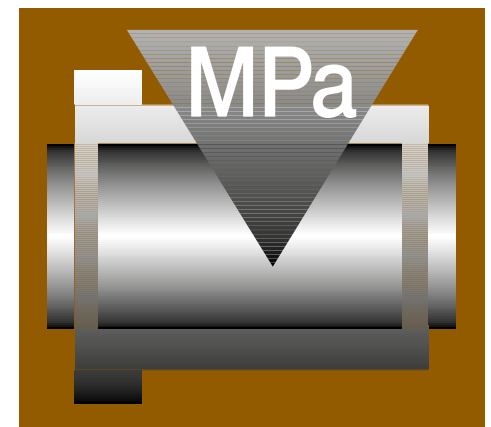

The heavy-duty bearing for up to 200MPa static and 140MPa dynamic

For pivoting applications under extreme loads

iglidur® TX1



When to use it?

- When very high permanent static loads occur
- For highly loaded pivoting movements
- When not only high loads but also high temperatures and media resistance are required



When not to use?

- When loads of far less than 100MPa occur
iglidur® G, iglidur® Q2, iglidur® Q
- For rotational movements during continuous operation
iglidur® W300, iglidur® Z, iglidur® G
- For high-temperature applications with average load levels
iglidur® X, iglidur® J350, iglidur® H