



PA cage,  
stainless steel or  
glass balls

- Higher loads
- More cost-effective than two comparable bearings



## Order key

Type	Material	Design
------	----------	--------

## BB-6000-B180-10-ES-D

Ball bearings	Dimensions according to DIN 625-1	Race material	Cage material	Ball material	Double row
---------------	-----------------------------------	---------------	---------------	---------------	------------

## Cage material

10 = PA

Options:

## Ball material

ES = Stainless steel

GL = Glass

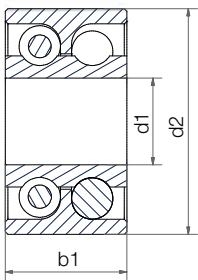

## Technical data

Installation size	Radial load capacity		Max. speed [rpm]	Weight	
	stat. [N]	dyn. [N]		PA/ES [g]	PA/GL [g]
6000	200	240	1,000	11.23	6.90
6004	420	470	650	35.60	22.55

## Dimensions [mm]

Inner Ø d1	Outer Ø d2	Width b1	Cage/ball material combination		Part No.
			PA/ES	PA/GL	
10	26	14	●	●	BB-6000-B180-10-□-D
20	42	20	●	●	BB-6004-B180-10-□-D



## Order example:

BB-6000-B180-10-ES-D = double row ball bearing with race material xirodur® B180, PA cage and stainless steel balls



Available  
from stock