

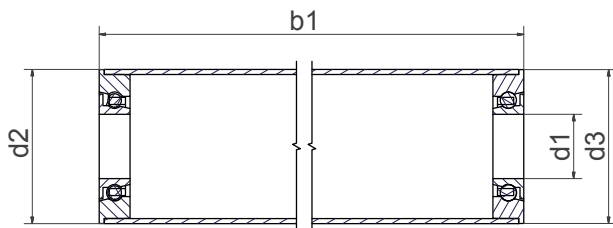

Carbon fibre tube with xirodur® S180 ball bearing, available as ESD version (with xirodur® F180 ball bearing)



Carbon fibre tube with xirodur® F180 ball bearing



Order key

Type

Material

BBT-CF 50-6004-□-30-ES

Ball bearing guide roller

Carbon fibre tube

Outer Ø

Dimensions according to DIN 625-1

Race material

Cage material

Ball material

Cage material

30 = xirodur® B180

Ball material

ES = Stainless steel

Dimensions [mm]

Inner Ø	Outer Ø	Flange Ø	Length	Part No.
d1	d2	d3	b1	
20	50	49.9	50–1,000	BBT-CF50-6004-S180-30-ES
20	100	100.0	50–1,000	BBT-CF100-6004-F180-30-ES



Order example:

BBT-CF50-6004-S180-30-ES, L=200mm = Carbon fibre tube with 2 ball bearings xirodur® S180, xirodur® B180 cage and stainless steel balls, total length 200mm



Delivery time: approximately 3 weeks

With xirodur® F180 as ESD version available upon request