

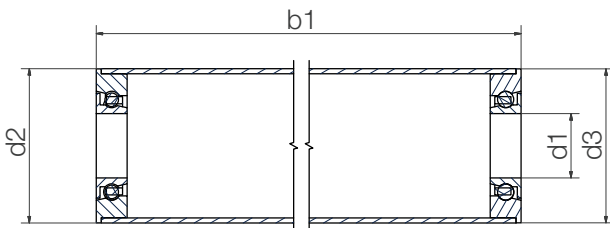

Aluminium tube with xirodur® B180 ball bearing

- Suitable for contact with food



Order key

Type

Material

BBT-AC 38-6000-B180-10-ES

Ball bearing guide roller

Aluminium tube

Outer Ø

Dimensions according to DIN 625-1

Race material

Cage material

Ball material



Radial deep groove ball bearings with flange also available as individual parts

▶Page 910

Cage material

10 = PA

30 = xirodur® B180

Ball material

ES = Stainless steel

Dimensions [mm]

Inner Ø	Outer Ø	Flange Ø	Length	Part No.	
d1	d2	d3	b1		
6	20	19.9	50–500	BBT-AC20-606-B180-30-ES	New
8	20	19.9	50–500	BBT-AC20-688-B180-30-ES	New
8	30	29.9	50–1,500	BBT-AC30-608-B180-10-ES	
10	30	29.9	50–1,500	BBT-AC30-6000-B180-10-ES	
12	30	29.9	50–1,500	BBT-AC30-6001-B180-10-ES	
10	38	37.9	50–1,500	BBT-AC38-6000-B180-10-ES	
12	38	37.9	50–1,500	BBT-AC38-6001-B180-10-ES	
15	38	37.9	50–1,500	BBT-AC38-6002-B180-10-ES	
17	38	37.9	50–1,500	BBT-AC38-6003-B180-10-ES	
20	50	49.9	50–1,500	BBT-AC50-6004-B180-30-ES	
20	60	59.9	50–1,500	BBT-AC60-6004-B180-30-ES	



Online configurator for xiros® system solutions

▶ www.igus.eu/xirosAlu

Order example:

BBT-AC38-6000-B180-10-ES, L=500mm = Aluminium tube with 2 ball bearings with race material xirodur® B180, PA cage and stainless steel balls, total length 500mm



Available

from stock