



Single or double row,  
with stainless steel or glass balls



Order key

Type

Material

BB-51104-B180-ES-D

Ball bearings

Dimensions according  
to DIN 711

Race/cage material

Ball material

Double row

Options

**Ball material**

**ES** = Stainless steel

**GL** = Glass

**Suffix**

**Blank** = Single row

**D** = Double row

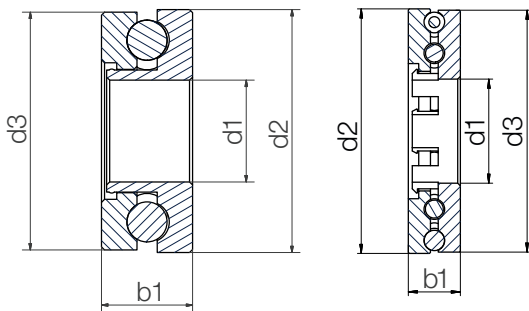

Single row bearing

Double row bearing

### Technical data

Installation size	Single row	Double row	Load capacity		Max. speed [rpm]	Weight	
			stat. [N]	dyn. [N]		B180/ES [g]	B180/GL [g]
51100	●	–	200	250	600	6.61	4.12
51104	●	–	650	810	460	13.72	8.19
51104	–	●	975	1,215	460	18.96	8.99

### Dimensions [mm]

Inner Ø d1	Outer Ø		Width b1	Cage/ball material combination		Part No.
	d2	d3		B180/ES	B180/GL	
10	24	23.5	9	●	●	BB-51100-B180- <input type="checkbox"/>
20	35	34.5	10	●	●	BB-51104-B180- <input type="checkbox"/>
20	47	46.5	10	●	●	BB-51104-B180- <input type="checkbox"/> -D



Order example:

BB-51100-B180-ES = Thrust bearing with race material xirodur® B180, B180 cage and stainless steel balls



Available  
from stock