

**Central Lubrication Pumps for Grease, electrically operated**

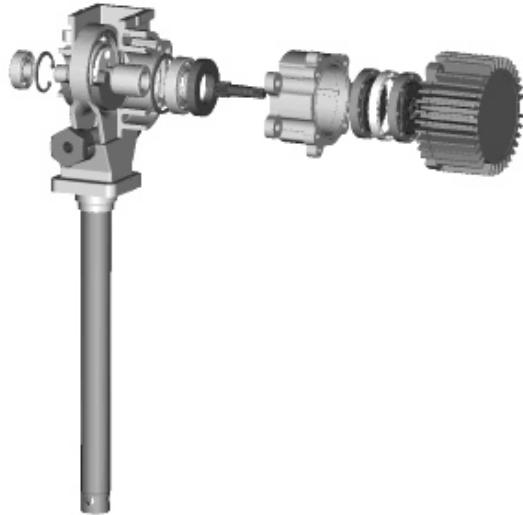

**A**

24 VDC FlowMaster Pump

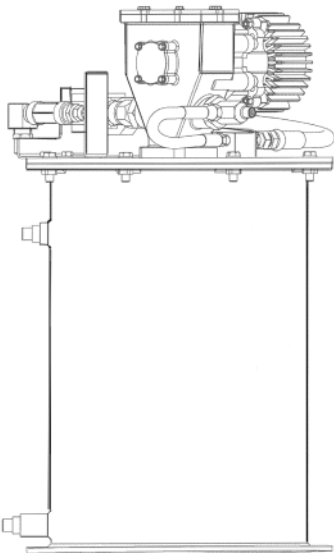

**B**

24 VDC FlowMaster Centro-Matic Pump

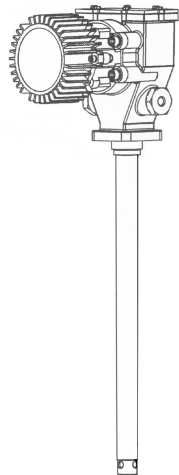

**C**

FlowMaster Piston Pump with 24 VDC Motor  
Pump tube-Ø ~ 32 mm (1-1/4")  
Pump outlet 1/4" NPTF female

**FlowMaster Pumps**

with electric 24 V DC-Motor for automated grease lubrication systems.

Figure (A) illustrates the design of the rotary drive of the piston pump: Heavy duty pump housing with eccentric crank mechanism, pump shaft supported by ball bearings, gear box housing, planetary gear and powerful, brushless 24V DC-Motor with motor cover. Variable motor speed setting by built-in potentiometer. Motor overload protection.

The piston pump discharges the lubricant on Up- and Down-stroke.

FlowMaster Pumps with 24 VDC drive are available in different gear ratios and pump tube lengths.

**FlowMaster Pumps with Bucket (figure B)**

for Centro-Matic single-line lubrication systems using metering valves type SL-32, SL-33, SL-1 and SL-11 or a combination of these.

The vent valve assembly of the pump is equipped with a 24 V DC 2/2-way solenoid valve.

System Controller, Pressure Switch, Relais and Fuse by user. The pumps are designed for pumping grease up to NLGI class 2.

The bucket pumps listed below have a gear ratio of 5:1 and mainly differ in the reservoir capacity.

Pump Model	Total Height	Total Weight	Reservoir Capacity
No. 85471	~699 mm	41 kg	27 kg ( 60 lbs)
No. 85472	~965 mm	44 kg	41 kg ( 90 lbs)
No. 85473	~989 mm	102 kg	54 kg (120 lbs)

Heavy-duty steel reservoir with follower and fill inlet port. Enhanced mechanical low level indicator. Model 85473 is additionally equipped with conduit box and micro switch for low level monitoring.

**Technical Data**

Operating Voltage:	24 VDC
VDC-Motor:	0,37 kW
Current Draw <sup>1)</sup> :	see note
Gear, single stage:	5 : 1
Pump-Speed	
adjustable	min. to max. : 36-360 rpm
Pump output:	~ 1,15 cm <sup>3</sup> /cycle
Output / min <sup>2)</sup>	min. to max. : approx. 45 to 412 cm <sup>3</sup>
Operating Pressure <sup>3)</sup> :	275 bar
Operating Temperature <sup>4)</sup> :	-40° C to +65° C
Material outlet :	1/2" NPT male

**Notes:**

<sup>1)</sup> The current draw depends on the back pressure; for example 12 A at approx. 275 bar. A field installed fuse of 20 A is recommended.

<sup>2)</sup> The pump output is proportional to the pump RPM which depends on the speed adjustment and the back pressure.

<sup>3)</sup> FlowMaster Pumps have a maximum pressure rating of 345 bar. The pressure relief valve of the pump is factory set to 275 bar and is not adjustable. Limit the pump operating pressure by a pressure switch (by user) not to exceed the maximum system pressure which is 240 bar for Centro-Matic grease systems.

<sup>4)</sup> Depends on the lubricant and the specific system lay-out of the Centro-Matic single-line central lubrication system.

Model	Basic-Pump (fig. C)	Pump tube length
No. 85471	No. 85567 (*)	~ 483 mm
No. 85472	No. 85568 (*)	~ 699 mm
No. 85473	No. 85568 (*)	~ 699 mm

(\*) Equipped with Pressure Relief Valve No. 272722 .